

Audrey Zapp Drive Corridor Priority Projects

STATION 2: AUDREY ZAPP DRIVE CORRIDOR PRIORITY PROJECTS



Where We're At:

The Audrey Zapp Drive Corridor Priority Projects have been identified as projects for implementation in the near term. There are four priority projects: 1. Audrey Zapp Drive Gateway; 2. Marina Green; 3. CRRNJ Terminal Plaza; and 4. the Historic Train Shed. The design team is continuing to develop the design of these areas, incorporating public feedback received to date.

Station

#2

Liberty State Park Revitalization Program

OPEN HOUSE: January 25, 2025 - Liberty Science Center, 222 Jersey City Blvd, Jersey City, NJ



NEW JERSEY
DEPARTMENT OF
ENVIRONMENTAL
PROTECTION

with:

ARUP

WRT

WXY

Vision

Biohabitats

Studio

MATRIX

NEWORLD

PACA

HR

Anticipated 2025 Groundbreaking: Marina Green Flex Fields - Priority Project

STATION 2: AUDREY ZAPP DRIVE CORRIDOR PRIORITY PROJECTS



Features and Improvements:

- Upgrading the lawn
- Promenade walkway along the flex fields
- Shaded seating integrated into the promenade

EXISTING

NEW PLANTING

PLAY

GATHER

Activities these flex fields can accommodate:

- Pick-up games
- Pop-up events
- Picnics
- Lounging

What other activities should occur at these flex fields?

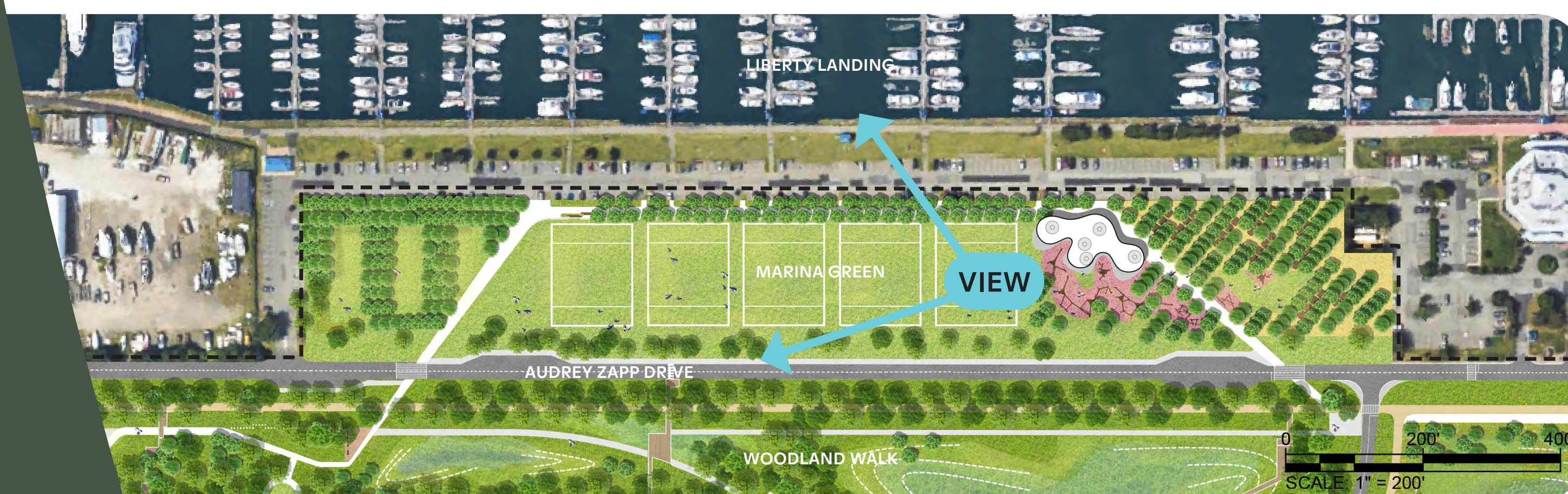

How it looks today



What do you think of this vision for the Marina Green Flex Fields? Is there anything you would add?

Please share your thoughts on a post-it note here or on the image above:

Station

#2

Liberty State Park Revitalization Program

OPEN HOUSE: January 25, 2025 - Liberty Science Center, 222 Jersey City Blvd, Jersey City, NJ



NEW JERSEY
DEPARTMENT OF
ENVIRONMENTAL
PROTECTION

with:

ARUP

WRT

WXY

Vision

Biobabitats

Studio

MATRIX

NEWORLD

PACA

HERA

Anticipated 2025 Groundbreaking: Marina Green Picnic Grove - Priority Project

STATION 2: AUDREY ZAPP DRIVE CORRIDOR PRIORITY PROJECTS



Features and Improvements:

- Picnic tables
- Trees that provide a shaded picnic grove
- Play area
- Building with restrooms

EXISTING

NEW PLANTING

PLAY

GATHER

Activities this picnic grove can accommodate:

- Eating outside
- Gathering
- Play

What other activities should occur in this picnic grove?

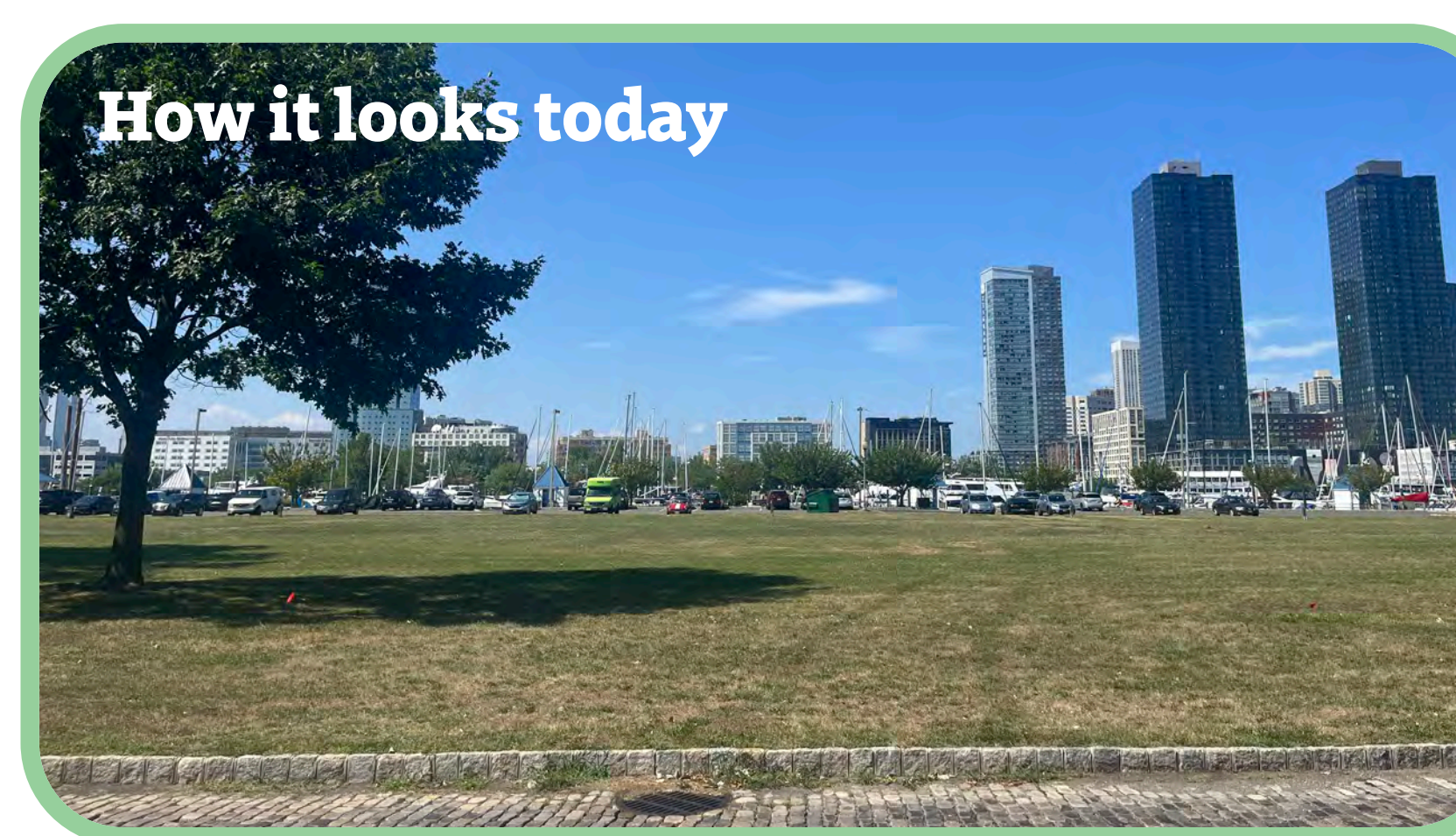

What do you think of this vision for the Marina Green Picnic Grove? Is there anything you would add?

Please share your thoughts on a post-it note here or on the image above:

Station

#2

Liberty State Park Revitalization Program

OPEN HOUSE: January 25, 2025 - Liberty Science Center, 222 Jersey City Blvd, Jersey City, NJ



NEW JERSEY
DEPARTMENT OF
ENVIRONMENTAL
PROTECTION

with:

ARUP

WRT

WXY

Vision

Biobiohabitats

Studio

MATRIX

NEW WORLD

PACA

HEX

Anticipated 2025 Groundbreaking: CRRNJ Terminal Plaza - Priority Project

STATION 2: AUDREY ZAPP DRIVE CORRIDOR PRIORITY PROJECTS



Features and Improvements:

- Replacing non-ADA compliant paving
- Adding seating
- Enhancing entrance to the CRRNJ Terminal Concourse
- Maintaining open views

EXISTING

NEW PLANTING

GATHER

CIRCULATION

Activities this plaza can accommodate:

- Tour group meet ups
- Seated event space

What other activities should occur in this plaza?

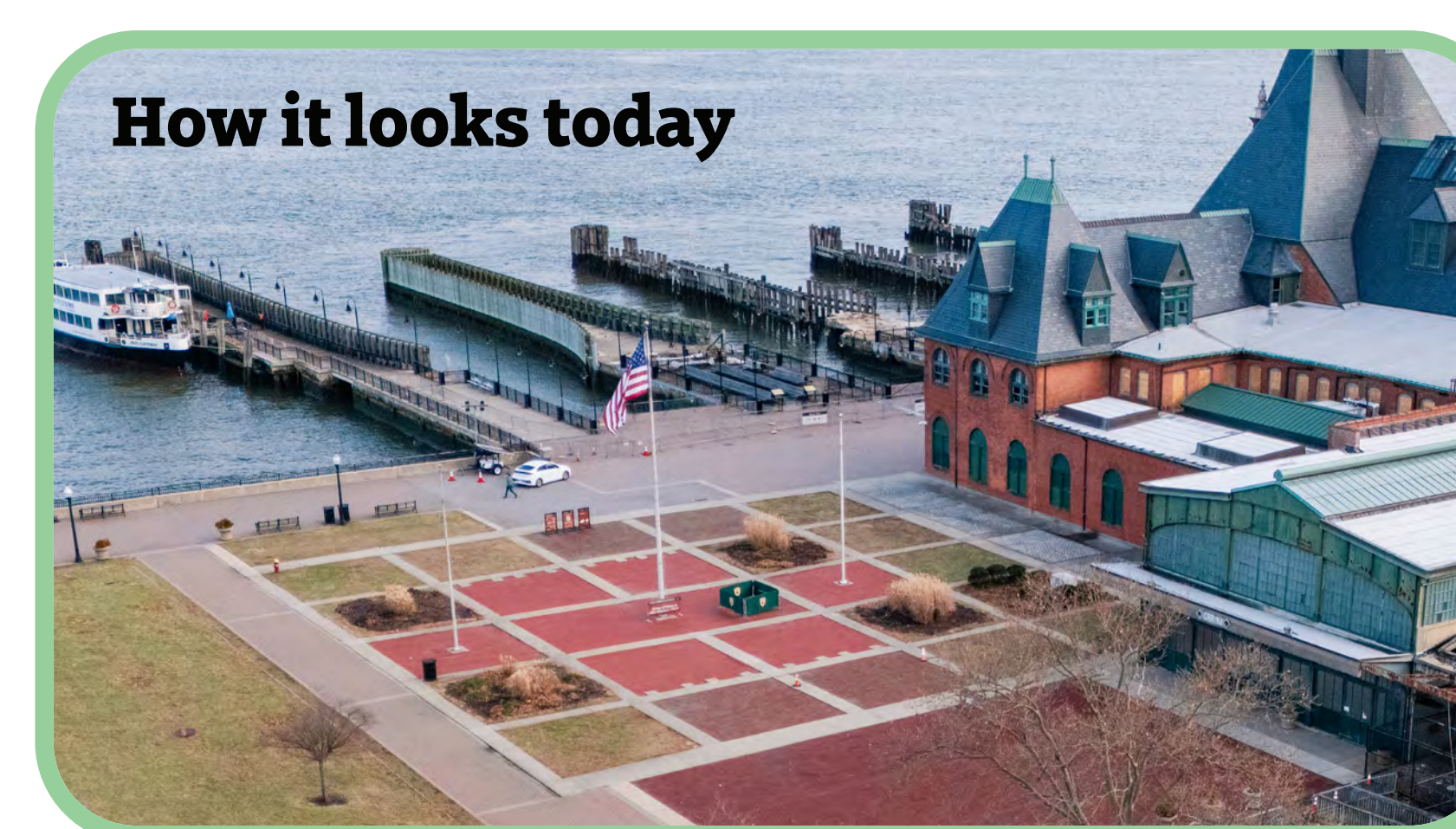

What do you think of this vision for the CRRNJ Terminal Plaza? Is there anything you would add?

Please share your thoughts on a post-it note here or on the image above:

Station

#2

Liberty State Park Revitalization Program

OPEN HOUSE: January 25, 2025 - Liberty Science Center, 222 Jersey City Blvd, Jersey City, NJ



NEW JERSEY
DEPARTMENT OF
ENVIRONMENTAL
PROTECTION

with: ARUP



WXY



Biohabitats



MATRIXNEWORLD

PACA

HR&A

Anticipated 2025 Groundbreaking: Audrey Zapp Drive Gateway - Priority Project

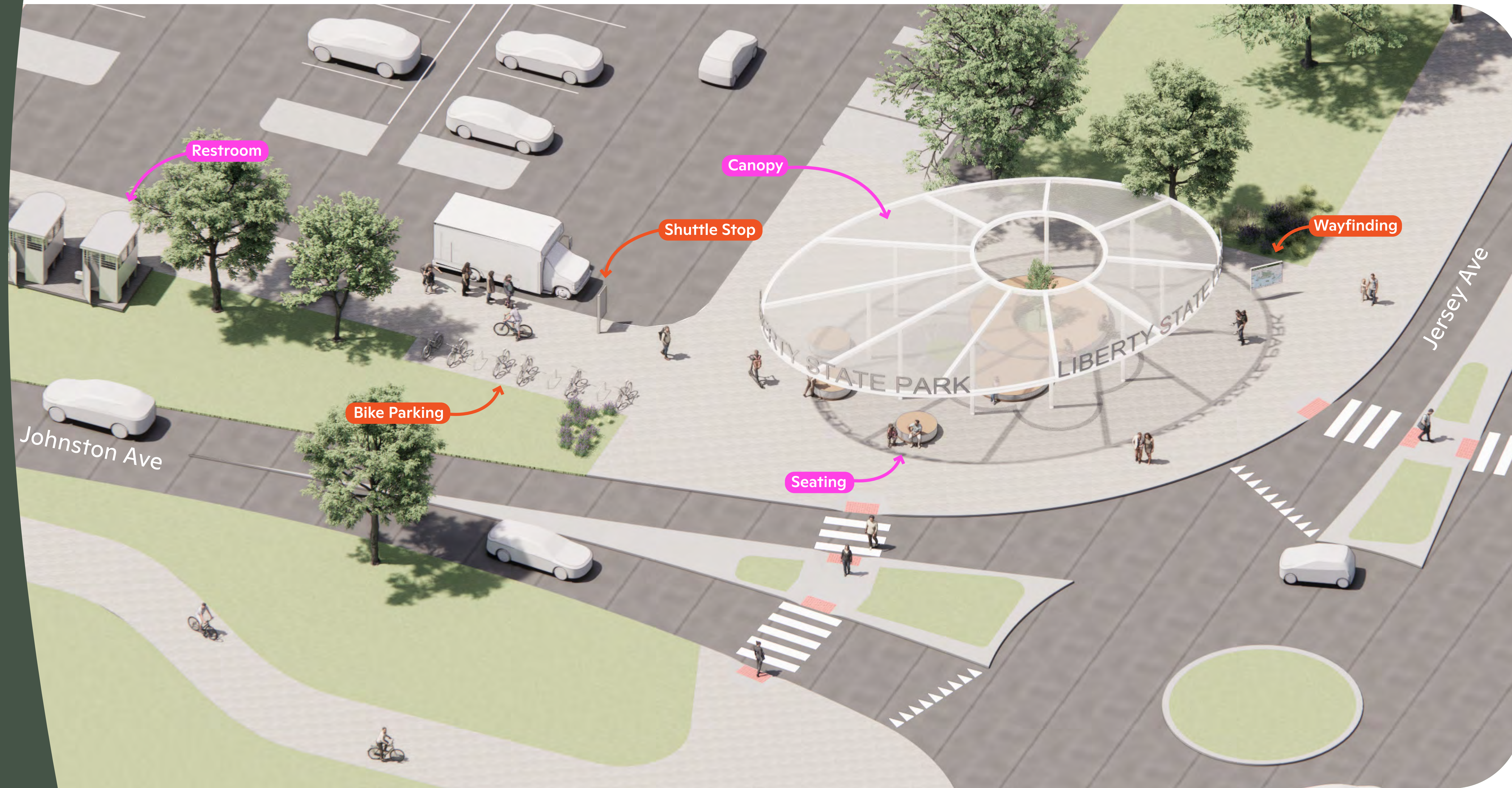

EXISTING

NEW PLANTING

GATHER

CIRCULATION

Features and Improvements

- Canopy
- Wayfinding
- Bike Rentals
- Parking
- Restrooms

Activities the Gateway can accommodate:

- Meeting point
- Restrooms
- Wayfinding

What other activities should occur here?



How it looks today



What do you think of this vision for the Gateway? Is there anything you want to change?

Please share your thoughts on a post-it note here or on the image above:

STATION 2: AUDREY ZAPP DRIVE PRIORITY PROJECTS

Station

#2

Liberty State Park Revitalization Program: LSP-North

OPEN HOUSE: January 25th, 2025 - Liberty Science Center, 222 Jersey City Blvd, Jersey City, NJ

Liberty State Park - North (Detailed Design) +
South (Holistic Long-Term Southern Area and
Waterfront Master Plan)



NEW JERSEY
DEPARTMENT OF
ENVIRONMENTAL
PROTECTION

with: ARUP

WRT

WXY

Vision

Biobehaviors

Studio

MATRIX

NEWORLD

PACA

HR

Anticipated 2025 Groundbreaking: Historic Train Shed - Priority Project

Project Process

SITE INVESTIGATION

CONCEPT DESIGN

SCHEMATIC DESIGN

DESIGN DEVELOPMENT

CONSTRUCTION DRAWINGS

PERMITTING

CONSTRUCTION

COMPLETION

we are here

What is the historical preservation process and would it affect the structure?

What are the Steps in the State Historic Preservation Office (SHPO) Process?

1 Project Start

The project team informs SHPO about the proposed project. They also notify consulting parties, like local communities, historic groups, and property owners about the planned changes.

2 Identification of Historic Properties

The team surveys the site to see if any historic buildings or areas will be affected. SHPO reviews this and decides if the property is eligible for the National Register of Historic Places.

3 Understanding Project Impacts

SHPO evaluates how the project will impact the historic site. They determine if the changes will harm the property's historic features or not.

4 Minimizing Negative Effects

If the project negatively affects the historic property, SHPO works with the team to find ways to minimize damage. This could include modifying designs or incorporating historic preservation methods.

5 Final Approval

Once an agreement is reached, SHPO signs off on the project, and work can begin, as long as it follows the agreed guidelines to protect the historic site.

How are we prioritizing the redevelopment of the Historic Train Shed?

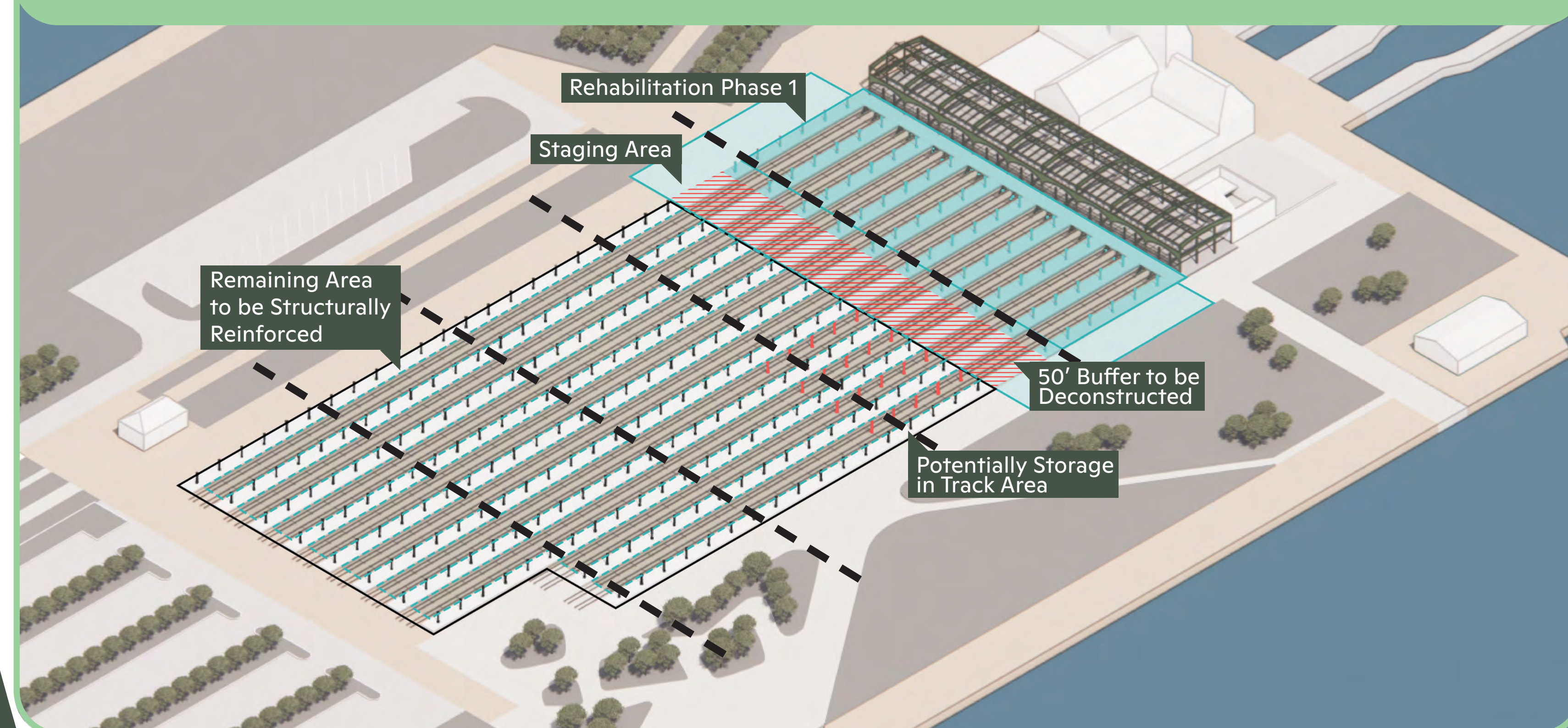

How are we activating the Shed?

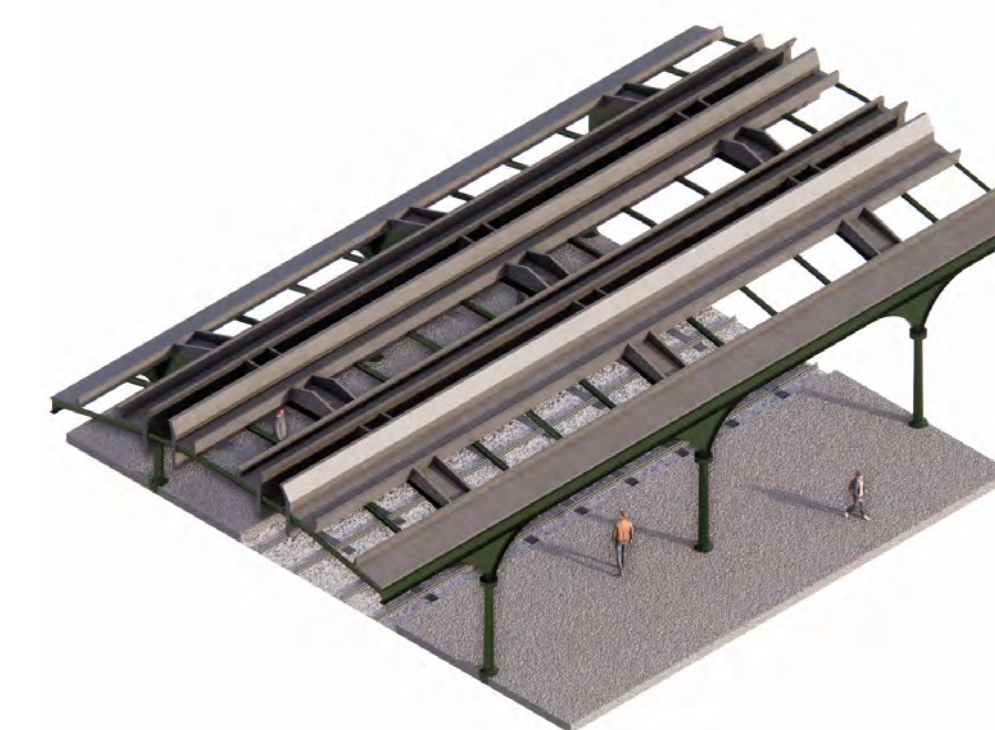

Rehabilitated Structure

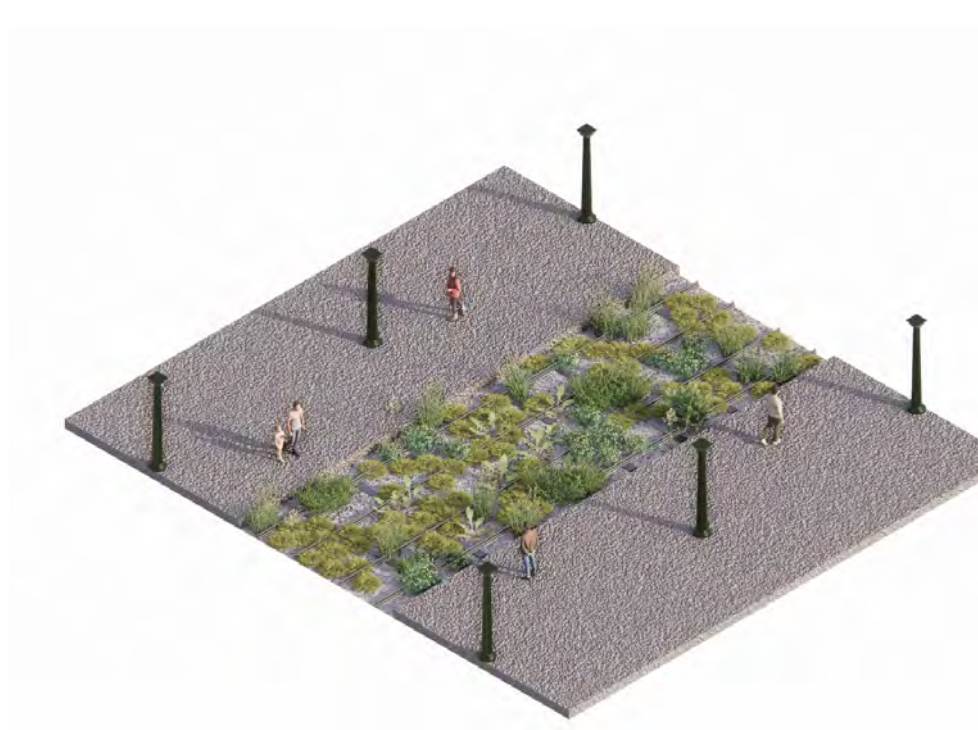

Landscape



Bridges

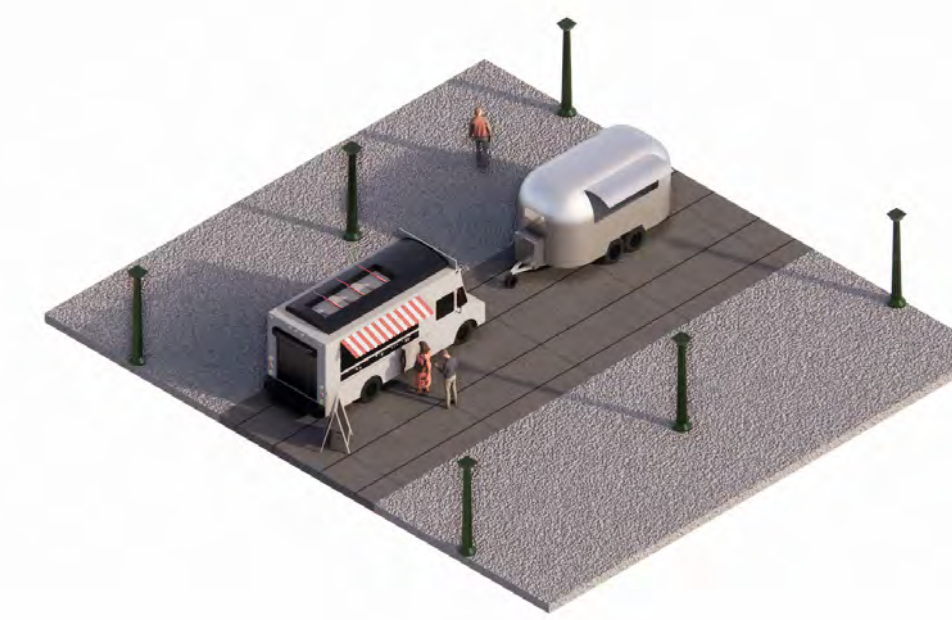

Food Trucks

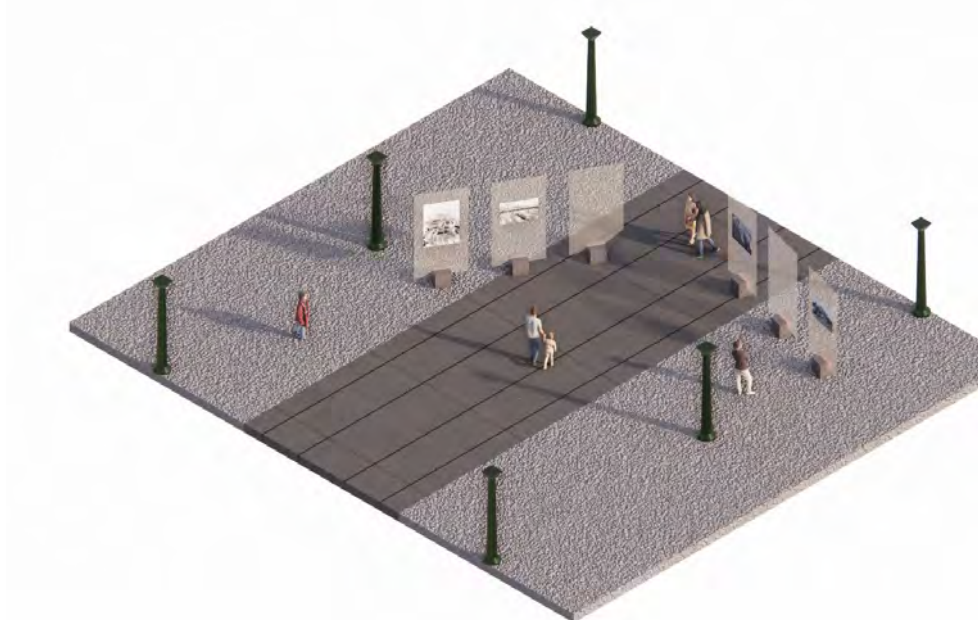

Historic Exhibit

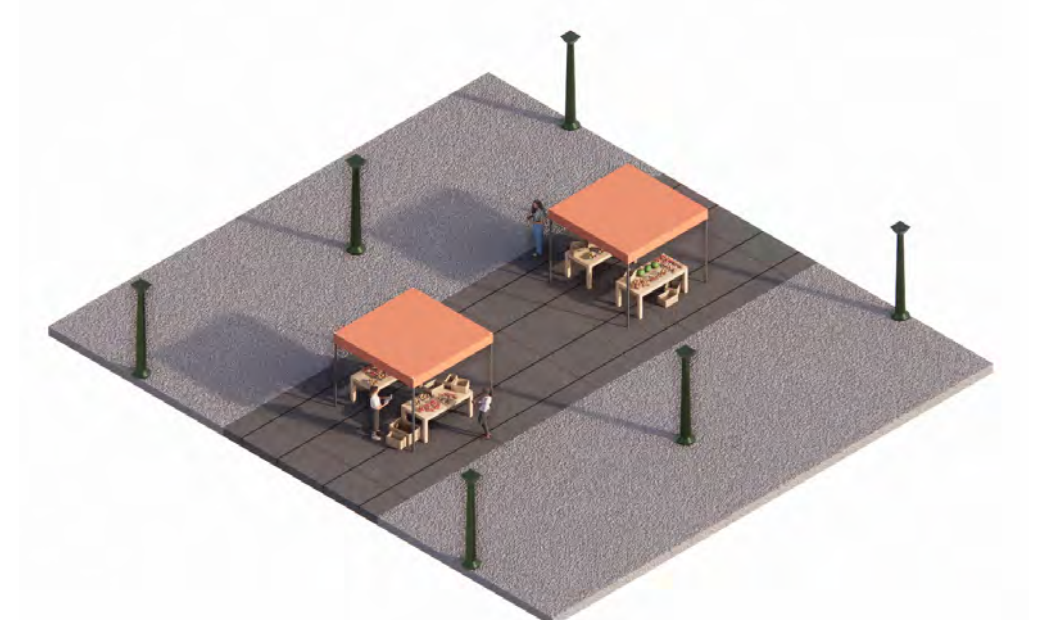

Market Kiosks

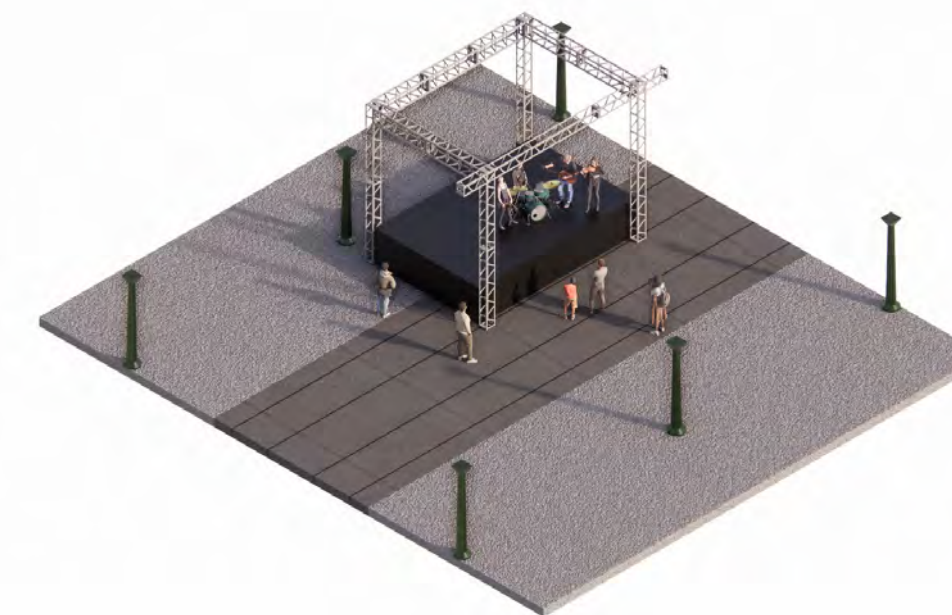

Music

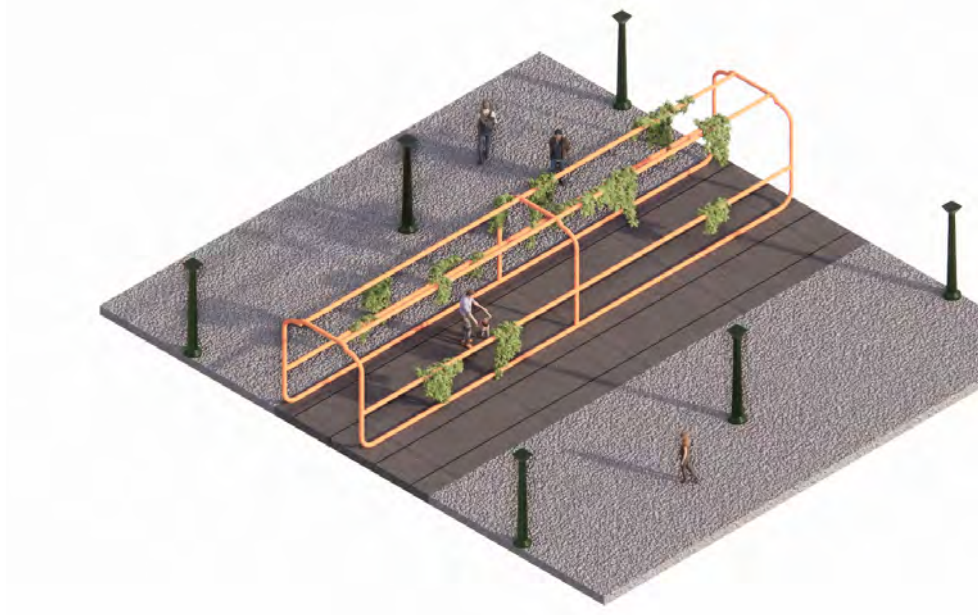

Trellis

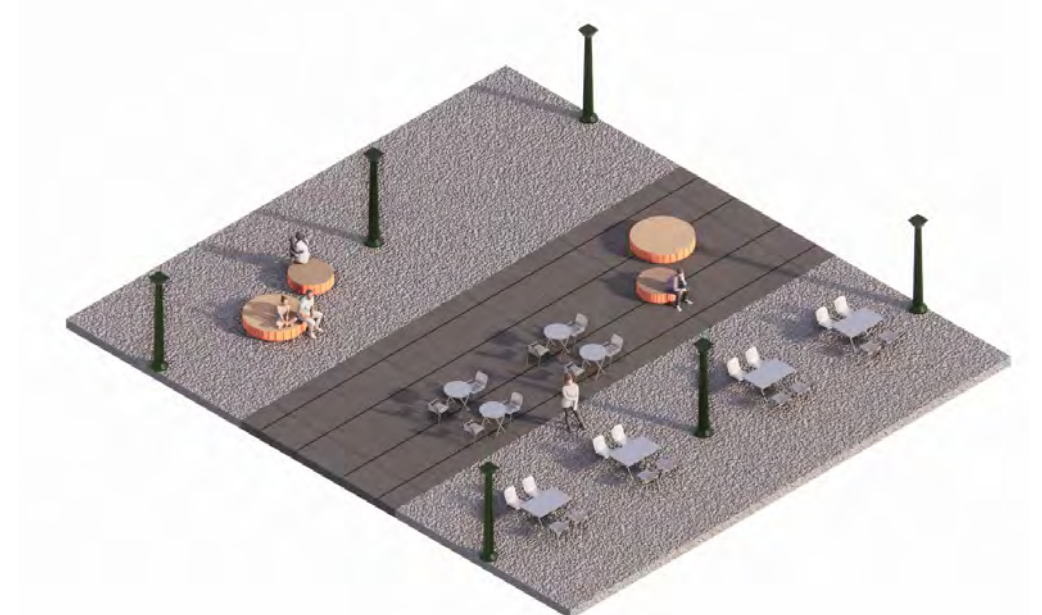

Movable Seating

What more do you want to learn about the Shed?

Please share your thoughts on a post-it note here or on the image above:

STATION 2: AUDREY ZAPP DRIVE PRIORITY PROJECTS

Station

#2

Liberty State Park Revitalization Program: LSP-North

OPEN HOUSE: January 25th, 2025 - Liberty Science Center, 222 Jersey City Blvd, Jersey City, NJ

Liberty State Park - North (Detailed Design) + South (Holistic Long-Term Southern Area and Waterfront Master Plan)



NEW JERSEY
DEPARTMENT OF
ENVIRONMENTAL
PROTECTION

with: ARUP



WXY



Biohabitats

Studio

MATRIX

NEWORLD PACA H&A

Anticipated 2025 Groundbreaking: Historic Train Shed - Priority Project

STATION 2: AUDREY ZAPP DRIVE PRIORITY PROJECTS



Features and Improvements

Restoration work of the train shed will take place in phases over time, with the first phase creating gathering space with seating and future interpretive programming.

- The Phase 1 closest to the Terminal Building rehabilitated and made accessible to the public
- Restored historic roof for seasonal uses and gathering, and outdoor seating spaces
- Historic exhibits related to the history of immigration and Ellis Island, and the history of the Central Railroad of New Jersey

EXISTING

NEW PLANTING

PLAY

GATHER

CIRCULATION

Activities the Shed can accommodate:

- Music events
- Gathering events
- Historic programming
- Events
- Market

What other activities should occur here?



What do you think of this vision for the Shed? Is there anything you want to change?

Please share your thoughts on a post-it note here or on the image above:

Station

#2

Liberty State Park Revitalization Program: LSP-North

OPEN HOUSE: January 25th, 2025 - Liberty Science Center, 222 Jersey City Blvd, Jersey City, NJ

Liberty State Park - North (Detailed Design) +
South (Holistic Long-Term Southern Area and
Waterfront Master Plan)



NEW JERSEY
DEPARTMENT OF
ENVIRONMENTAL
PROTECTION

with:

ARUP

WRT

WXY

Vision

Biohabitats

Studio

MATRIX

NEWORLD

PACA

HR&A

Audrey Zapp Drive Corridor Future Projects

View 1: Audrey Zapp Drive



View 2: Woodland Walk



View 3: North Cove



What do you think of this future vision? Is there anything you would add?

Please share your thoughts on a post-it note here or on the images above:

Station

#2

Liberty State Park Revitalization Program

OPEN HOUSE: January 25, 2025 - Liberty Science Center, 222 Jersey City Blvd, Jersey City, NJ



NEW JERSEY
DEPARTMENT OF
ENVIRONMENTAL
PROTECTION

with: ARUP



WXY



Biohabitats



MATRIX

NEWORLD

PACA

HR&A