

Liberty State Park Stakeholder Meeting

Updates on Interior Restoration and Active Recreation

June 3, 2021





Rules of Engagement

- Use the “*Questions*” chat to type any questions you would like answered
- If you want to speak, please use the *Raise Hand* function.
- Treat everyone with respect.
- Limit comments to two minutes — we will physically raise our hand as you approach 90 seconds.
- Please note that this meeting is being recorded and will be posted on the NJDEP website after the session concludes.

AGENDA

- Interior Restoration Design Updates
- Active Recreation Survey Highlights
- Next Steps
- Q & A





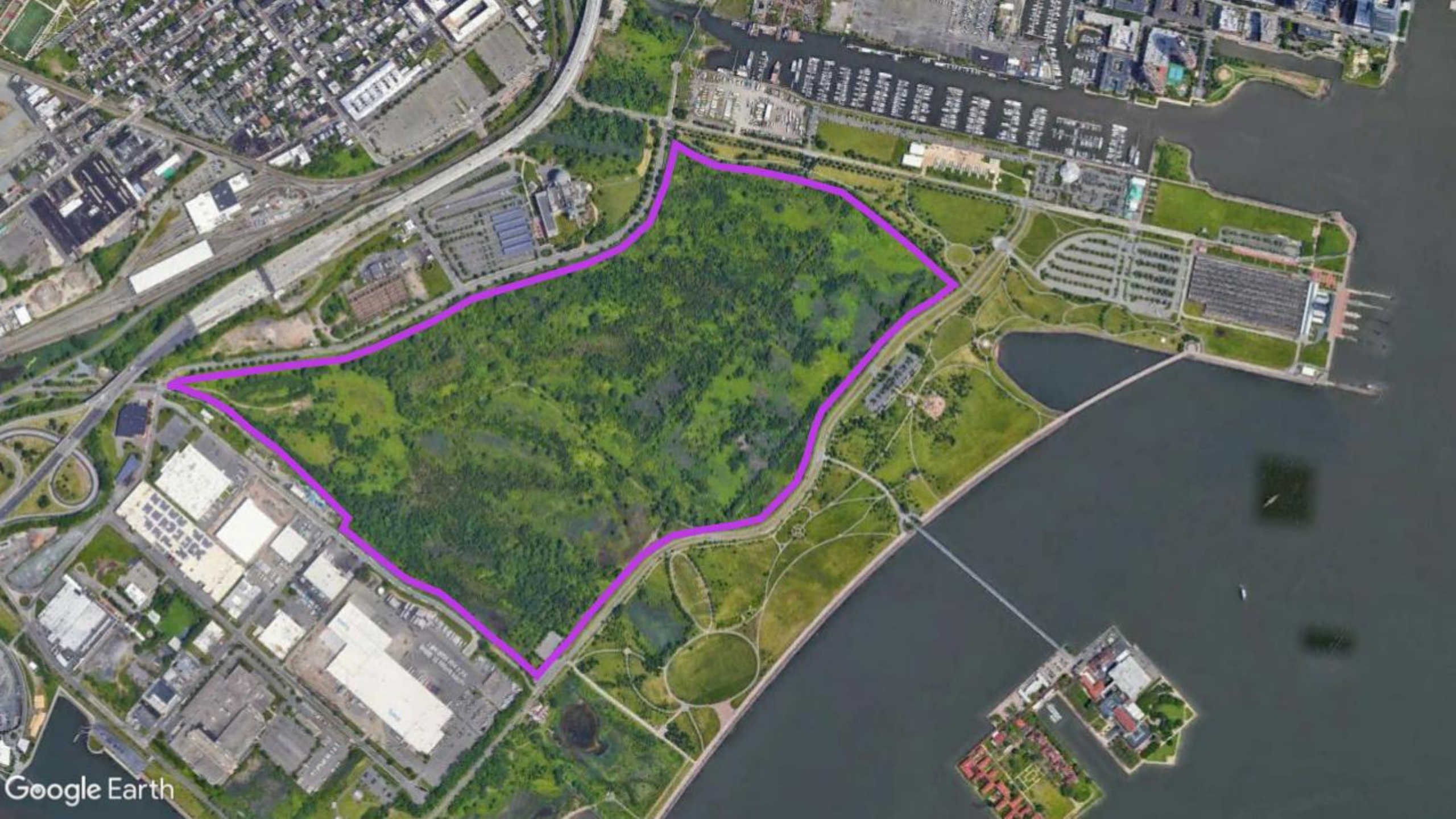

Interior Key Features



Tidal Wetlands

50 Acres



Non-tidal Wetlands

27 Acres



**Upland Forest and
Active Recreation**

133 Acres

Initial Concept
for Public Input
October 20th
Public Meeting

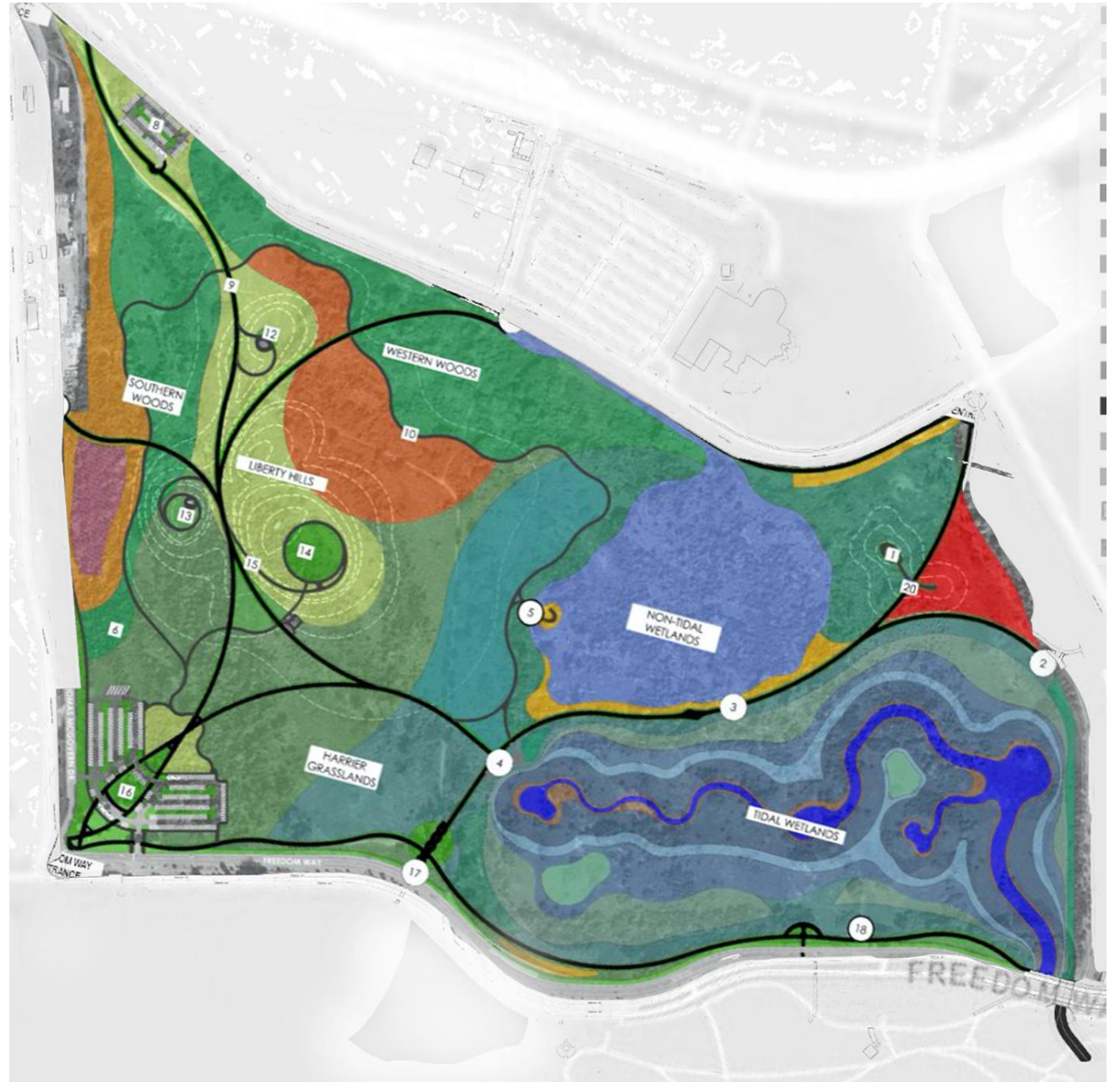



Recap of Public Engagement to Date

October 20, 2020

30% Concept Design and Initial Survey

January 7, 2021

Breakout Session I: Remediation

January 21, 2021

Breakout Session II: Options for Active Recreation

February 4, 2021

Breakout Session III: Ecological Restoration

February - April 2021

Active Recreation Survey

A new vision — meeting multiple uses

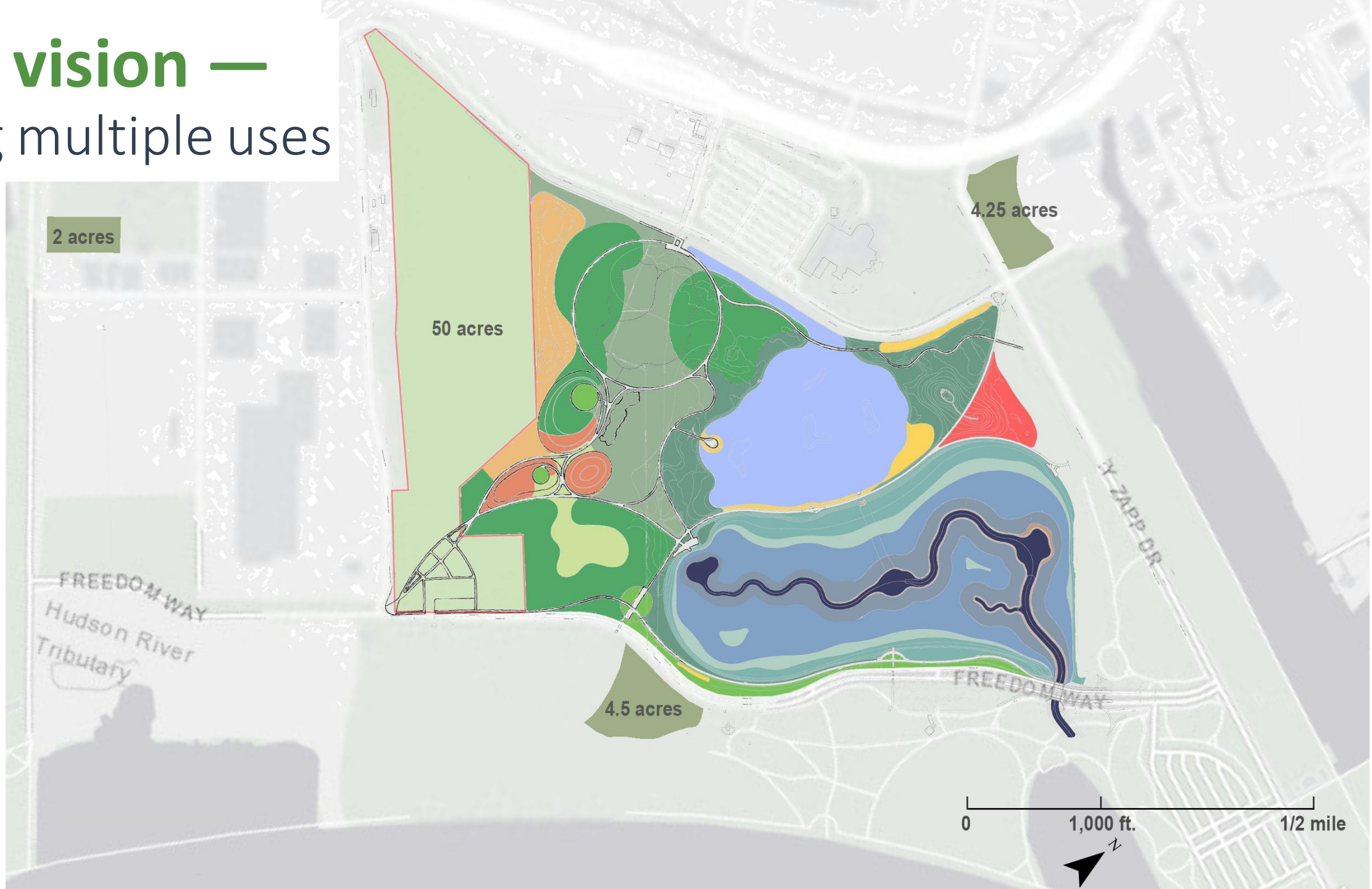

Reframed Passive Recreation Features

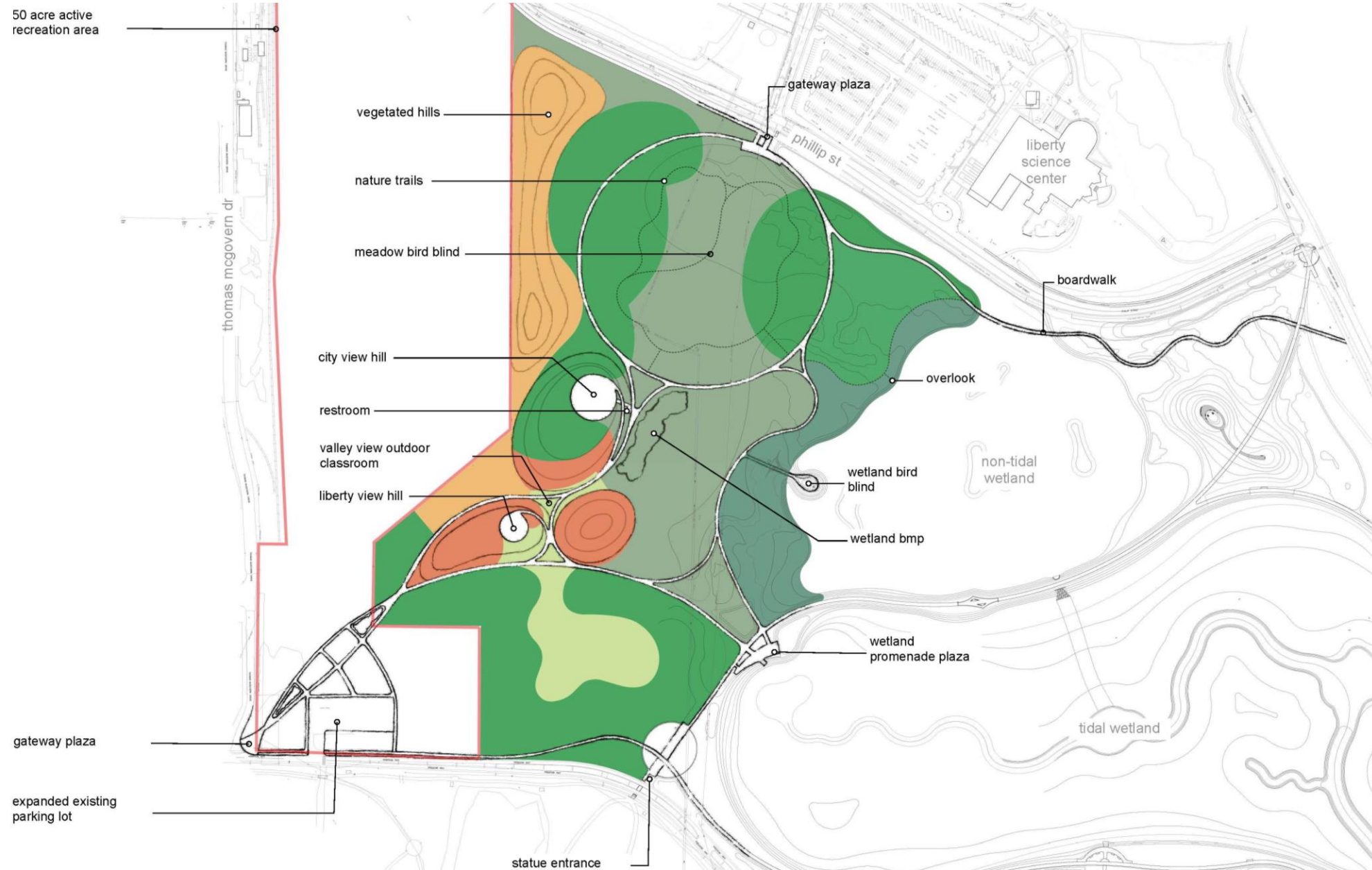

Integration and Circulation that Builds Connectivity Between and Among Uses

50 acre active
recreation area

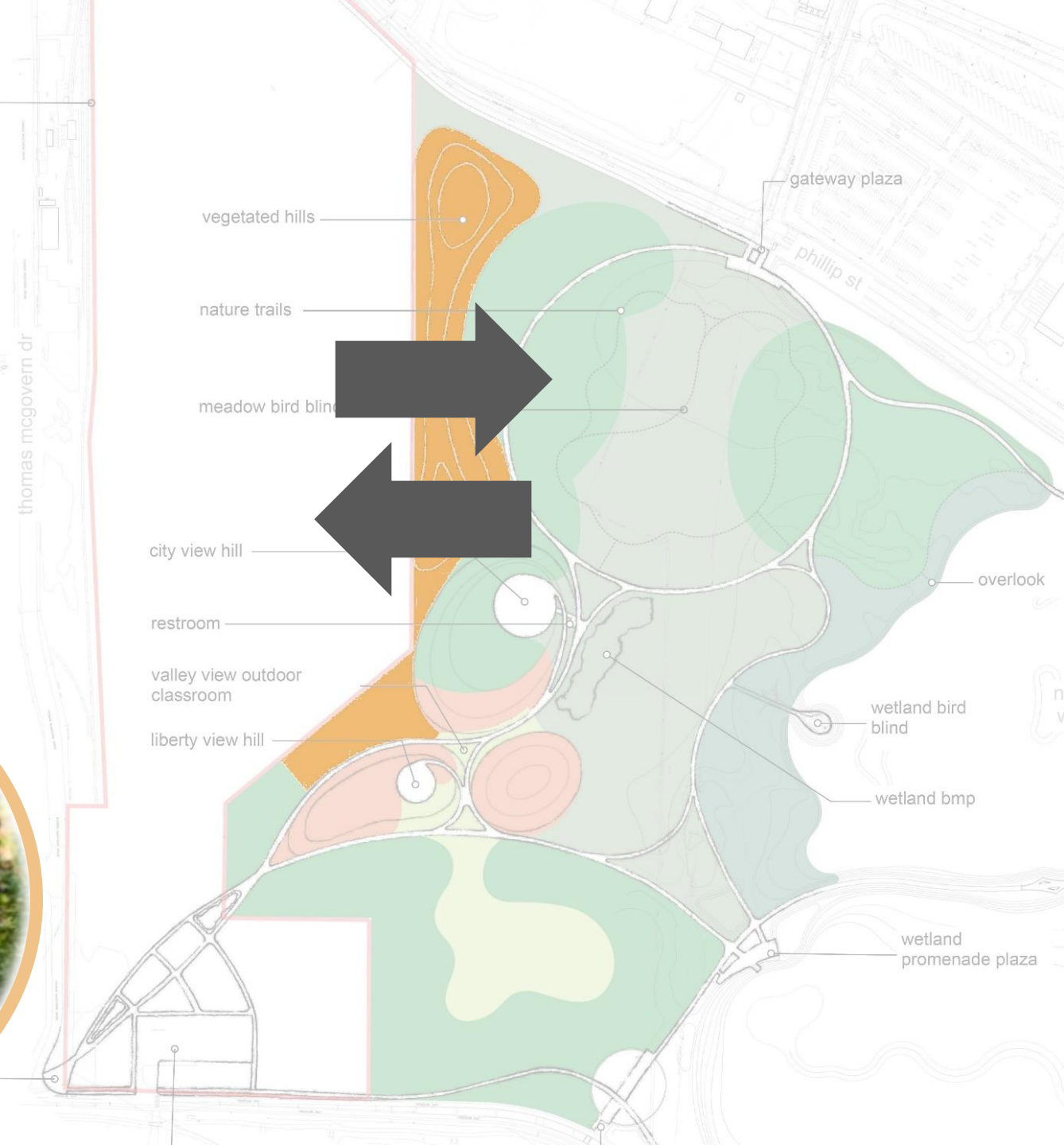

Survey Responses

3,652
responses

3,616
from New Jersey

3,266
from Hudson County

3,109
from Jersey City

<u>Age</u>	<u>#</u>	<u>%</u>
35-44	1160	31%
25-34	875	24%
45-54	612	16%
55-64	355	10%
65+	300	8%
Under 18	203	5%
18-24	147	4%

<u>ZIP</u>	<u>#</u>
07302	1063
07305	571
07306	455
07304	446
07307	425
07310	82
07002	59
07030	53
07303	19
07087	14

 = Jersey City Zipcode

Survey results: Sports Field Preferences

 <1%

 <1%

 1%

 4%

 6%

 9%

 22%

 23%

Rugby

Field Hockey

Lacross

Cricket

Football

Baseball

Track

Soccer

0.66%
0.71%

0.69%
1%

1%
2%

4.34%
4%

5%
8%

7%
11%

24%
21%

27%
20%

0.00% 5.00% 10.00% 15.00% 20.00% 25.00% 30.00%

■ 1st % ■ 2nd %

Survey results: Sports Court Preferences

 4%



9%

Badminton/Pickleball



11%

Skatepark



14%

Volleyball



22%

Tennis



22%

Basketball

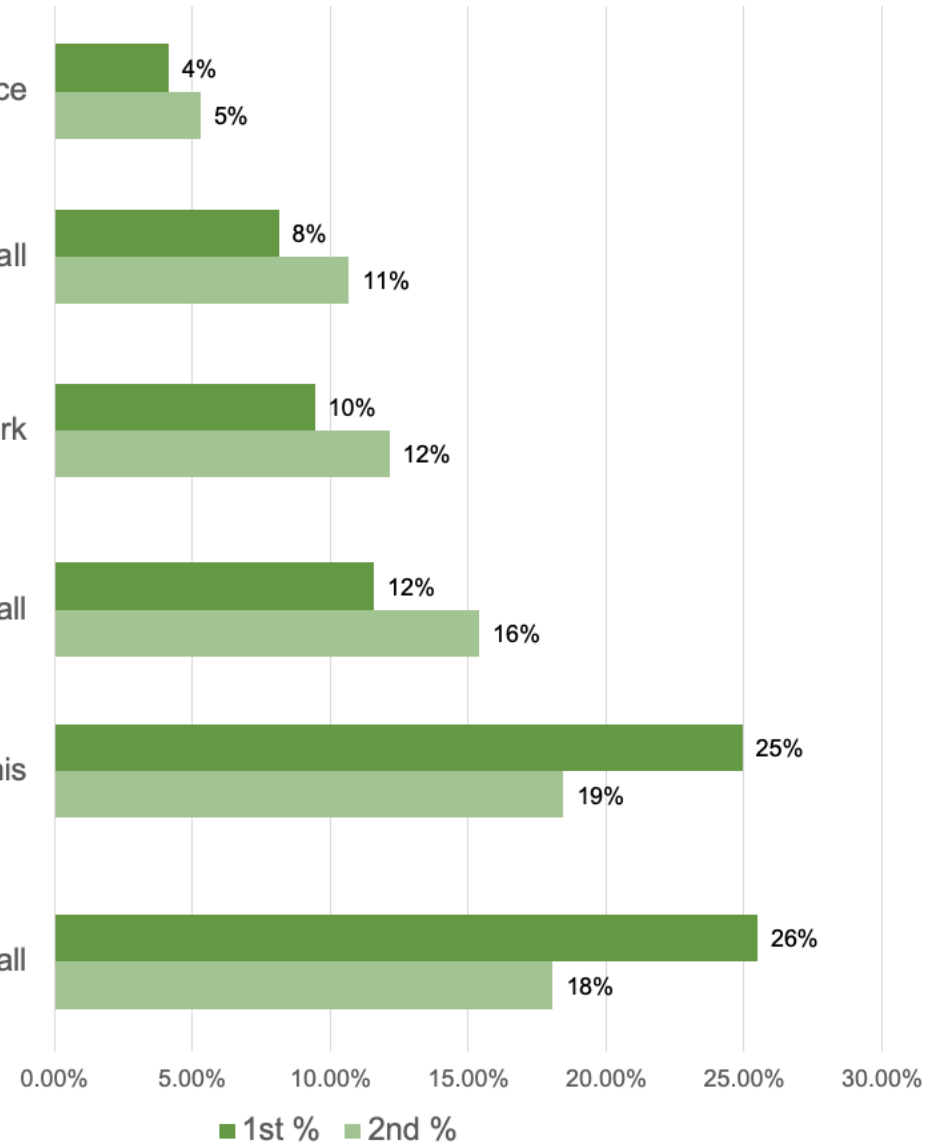

Survey results: Other Select Park Amenities Preferences



Dog Park

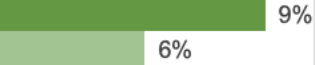

Water/Spray Park

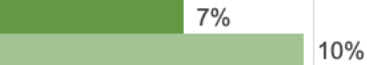

Playground



Boats/Kayaks



Public Garden

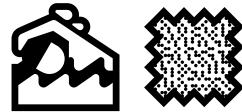

Pool

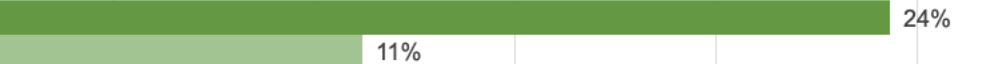

0.00% 5.00% 10.00% 15.00% 20.00% 25.00%

■ 1st % ■ 2nd %

Next Steps



Further the Ecological
Restoration Design



Begin Active Recreation
and Design

Thank You

Meeting recording will be
posted tomorrow 6/4 at:

nj.gov/dep/nrr/

Comment via Survey
until July 6:

[Bit.ly/lsp-update](https://bit.ly/lsp-update)

